

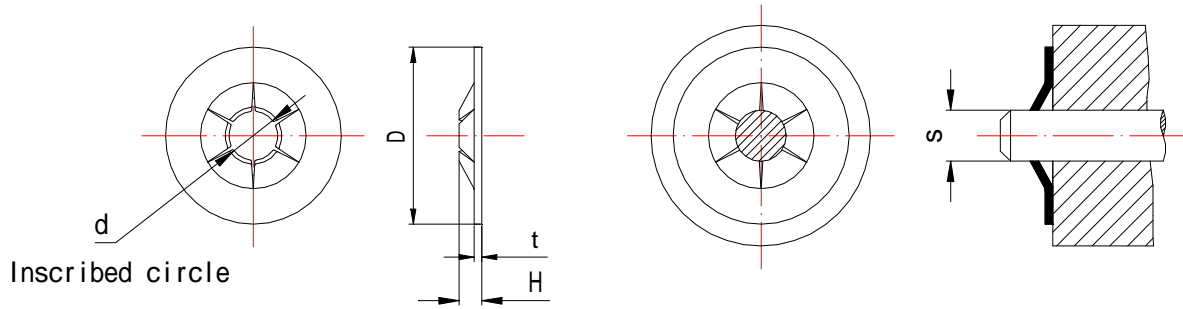

## Self-locking External Nuts

Installed



Unit: mm

Size-No.	Ring dimension					Applicable shaft		Thrust Load kgf
	d		D	H	t	S		
	Max.	Min.				Max.	Min.	
SPN- 1.2	1.1	1.0	4.5	0.6	0.25	1.24	1.17	20
1.5	1.4	1.3	5.2	0.6	0.25	1.54	1.47	20
2	1.9	1.8	6	0.7	0.25	2.04	1.97	20
2.4	2.3	2.15	7	0.8	0.25	2.44	2.37	45
2.6	2.5	2.35	7	0.9	0.25	2.64	2.57	45
3	2.9	2.75	10	1.3	0.3	3.05	2.97	100
4	3.9	3.75	12	1.4	0.3	4.05	3.97	100
5	4.9	4.75	14	1.55	0.4	5.05	4.97	150
6	5.9	5.75	16	1.75	0.4	6.06	5.97	170
8	7.9	7.75	17.5	1.8	0.5	8.06	7.97	180
10	9.9	9.75	21	2.2	0.7	10.07	9.97	320
12	11.9	11.75	27	2.8	0.9	12.07	11.97	400

Material=Carbon spring steel. Hardness=HRC40~50. Finish=Black phosphate coating (ACP).

Material=Stainless spring steel.

Note: 1. The data of thrust load shows the value when the nut is tested by the shaft made of cold rolled steel.

2. This ring can not use of hardened shaft.

## Self-locking Internal Nuts

Installed

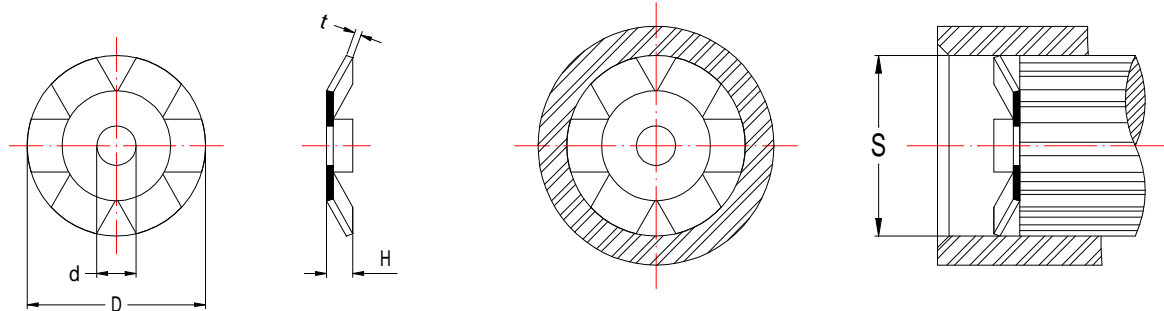

Circumscribed circle

Unit: mm

Size-No.	Ring dimension					Applicable shaft		Thrust Load kgf
	D		d	H	t	S		
	Max.	Min.				Max.	Min.	
RPN -6	6.3	6.1	1	1	0.3	6.03	5.94	40
8	8.3	8.1	1.8	1.2	0.3	8.03	7.94	50
10	10.3	10.1	3	1.4	0.4	10.03	9.93	80

Material=Carbon spring steel. Hardness=HRC44~52. Finish=Black phosphate coating (ACP).

Note: 1. The data of thrust load shows the value when the nut is tested by the bore made of cold rolled steel.

2. This ring can not use of hardened bore.

ALL RIGHTS RESERVED