

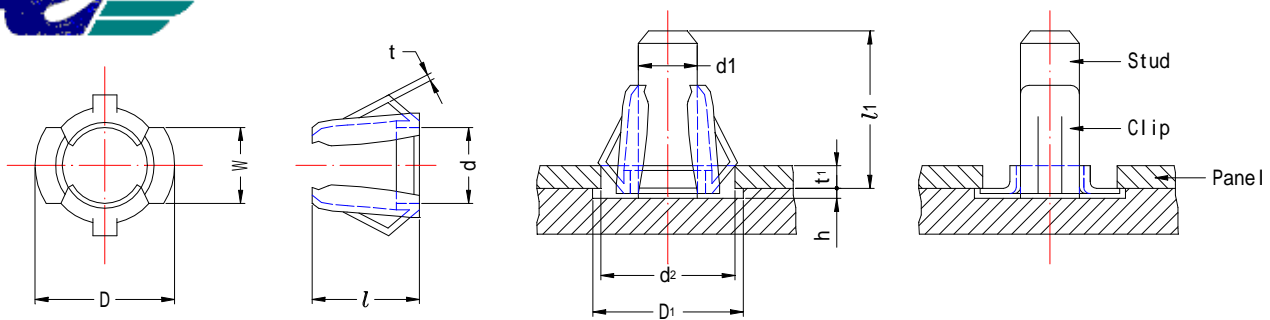

## Tubular Clips

Installed



Unit: mm

Size-No.	D		d		l		t	w		
	Max.	Min.	Max.	Min.	Max.	Min.		Max.	Min.	
TSN	-3	5.7	5.4	3.4	3.15	4.5	3.5	0.3	3.3	2.7
	4	6.7	6.4	4.4	4.15	5.5	4.5	0.3	3.8	3.2

Material= Stainless spring steel. Carbon spring steel. ~50. Finish=Black phosphate coating (ACP).

## Stud and Panel

Size-No.	D1	d1			l1	h	d2		t1	
		Min.	Max.	Min.			Min.	Max.	Min.	Max.
TSN	-3	6	3.1	3	6	0.5	4.6	4.5	0.9	0.6
	4	7	4.1	4	7	0.5	5.5	5.4	0.9	0.6

## P-Type Push-on Nuts

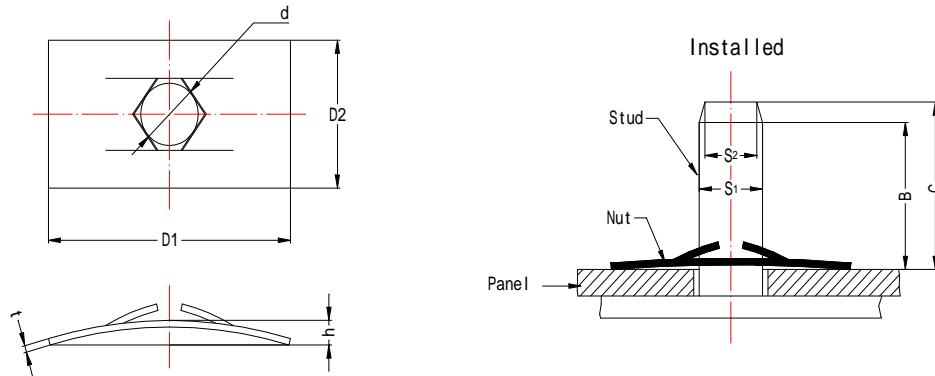

Unit: mm

Size-No.	Nut									Stud diameter				Thrust load kgf	
	d		D1	D2	Gen. Tol.	h		t	S1		S2	B	C		
	Max.	Min.				Max.	Min.		Max.	Min.					
PSN	-1.2	1.2	1.0	12	6.15	5.85	1.2	0.7	0.3	1.35	1.25	1	4.5	6	12
	1.5	1.48	1.28	12	6.15	5.85	1.2	0.7	0.3	1.62	1.52	1.2	4.5	6	12
	1.8	1.78	1.58	12	6.15	5.85	1.3	0.8	0.4	1.92	1.82	1.5	4.5	6	20
	2	1.95	1.75	12	6.15	5.85	1.25	0.75	0.4	2.12	2.02	1.6	4.5	6	23
	3	3.0	2.7	14	8.25	7.75	1.45	0.95	0.4	3.15	3.05	2.6	6	8	28
	4	4.0	3.7	16	9.25	8.75	1.75	1.25	0.4	4.15	4.05	3.6	6	8	28
	5	5.0	4.7	18	11.25	10.75	1.85	1.35	0.4	5.15	5.05	4.6	6	8	50
	6	6.0	5.7	20	12.25	11.75	1.95	1.45	0.4	6.15	6.05	5.6	8	10	50
8	8.0	7.7	23	15.25	14.75	2.45	1.95	0.5	8.15	8.05	7.6	8	10	50	

Material=Carbon spring steel. Hardness HRC40~50. Finish=Zn plating, Chromate dip.

Note: 1. The data of thrust load shows the value when the nut is tested by the stud made of cold rolled steel.

2. This nut can not use of hardened stud.

ALL RIGHTS RESERVED