

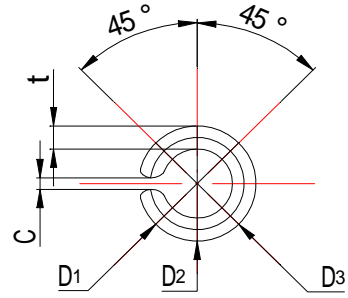

Spring Pins (For general use)

(JIS B 2808)
(JAPANESE INDUSTRIAL STANDARD)

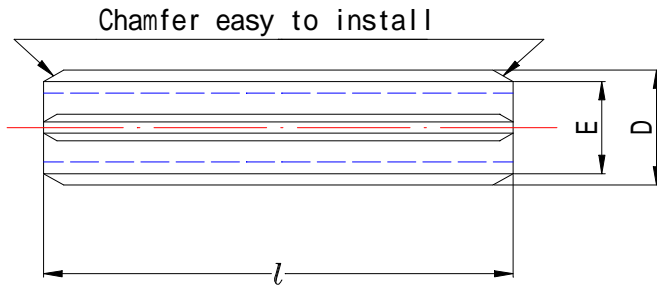

Unit: mm

Nominal dia.		1	1.2	1.5	1.6	2	2.5	3	3.5	4	4.5	5	6	8	10	12	13	
Dimension	D	Max.	1.2	1.4	1.7	1.8	2.25	2.75	3.25	3.84	4.4	4.84	5.4	6.4	8.6	10.6	12.5	13.7
		Min.	1.1	1.3	1.6	1.7	2.15	2.65	3.15	3.7	4.2	4.7	5.2	6.2	8.3	10.3	12.3	13.4
	t	Basic	0.2	0.25	0.3	0.3	0.4	0.5	0.6	0.7	0.8	0.9	1	1.2	1.6	2	2	2.5
	E	Max.	0.9	1.1	1.4	1.5	1.9	2.4	2.9	3.4	3.9	4.3	4.8	5.8	7.8	9.8	11.7	12.7
Double shear Strength kgf (KN)			70	104	158	171	281	440	633	861	1130	1425	1760	2532	4500	7030	8790	11500
			(0.69)	(1.02)	(1.55)	(1.68)	(2.76)	(4.3)	(6.2)	(8.44)	(11.08)	(13.97)	(17.25)	(24.83)	(44.13)	(68.94)	(86.2)	(112.78)
Hole Size	Max.	1.08	1.28	1.58	1.68	2.09	2.59	3.09	3.62	4.12	4.62	5.12	6.12	8.15	10.15	12.2	13.2	
	Min.	1	1.2	1.5	1.6	2	2.5	3	3.5	4	4.5	5	6	8	10	12	13	
Length L		Nominal dia.																
Max.	Min.	1	1.2	1.5	1.6	2	2.5	3	3.5	4	4.5	5	6	8	10	12	13	
4.5	4																	
5.5	5																	
6.5	6																	
8.5	8																	
10.5	10																	
13	12																	
15	14																	
17	16																	
19	18																	
21	20																	
23	22																	
25	24																	
26	25																	
29	28																	
33	32																	
37	36																	
41	40																	
46	45																	
51	50																	
56.5	55																	
57.5	56																	
61.5	60																	
64.5	63																	
71.5	70																	
81.5	80																	
91.5	90																	
101.5	100																	
111.5	110																	
121.5	120																	
126.5	125																	
141.5	140																	

Material=Carbon spring steel. Hardness=HRC45~50. Finish=Black phosphate coating (ACP).

Material=Stainless spring steel.

Note: Max. D shall be checked by a "Go" ring gage. Min. D shall be the average of the D1, D2, and D3 diameter.

For ordering please write nominal dia and length as well. Example: "SPP 4X20"

marks are according to our company's specification.

ALL RIGHTS RESERVED

DONGGUAN EAGLE SANKYOU SCREWS AND FASTENERS CO.,LTD.