

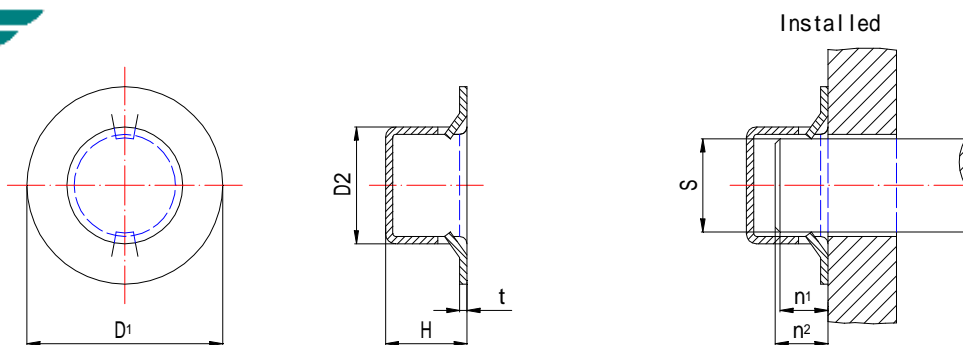

Cap Nuts (F-Type)



Unit: mm

Size-No.	Nut							Applicable shaft				
	D1		D2		H		t	S		n1 (Min.)	n2 (Max.)	
	Max.	Min.	Max.	Min.	Max.	Min.		Max.	Min.			
WS	-5	11.7	11.3	6.3	5.7	5.3	4.7	0.4	5.05	4.95	3	4
	6	12.2	11.8	7.4	6.8	5.3	4.7	0.45	6.05	5.95	3	4
	8	14.5	14.1	9.6	9.0	7.6	7.0	0.5	8.05	7.95	3	6

Material= Carbon spring steel. Hardness=40~50. Finish=Ni plating.

Note; This nut can not use of hardened shaft.

Cap Nuts (D-Type)

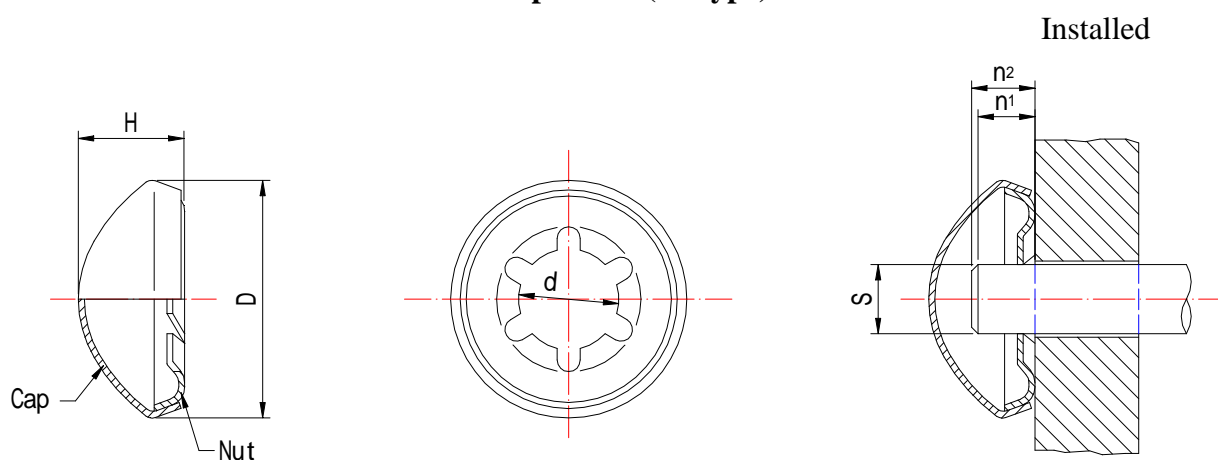

Unit: mm

Size-No.	Nut								Applicable stud				
	d		D		H		t1	t2	S		n1 (Min.)	n2 (Max.)	
	Max.	Min.	Max.	Min.	Max.	Min.			Max.	Min.			
DS	-5	4.9	4.75	13.3	12.7	5.8	5.2	0.3	0.3	5.05	4.97	2.5	4
	6	5.9	5.75	15.3	14.7	5.8	5.2	0.3	0.3	6.05	5.97	2.5	4
	8	7.9	7.75	15.9	15.3	5.8	5.2	0.3	0.3	8.05	7.97	2.5	4

Cap: Material=Stainless steel (SUS 304CS).

Cap: Material=Carbon spring steel. Hardness HRC40~50. Finish=Zn plating, Chromate dip.

Note: This nut can not use of hardened stud.

ALL RIGHTS RESERVED

DONGGUAN EAGLE SANKYOU SCREWS AND FASTENERS CO.,LTD.